

TAV. 16 - VERIFICA SUPERFICIE A PARCHEGGIO

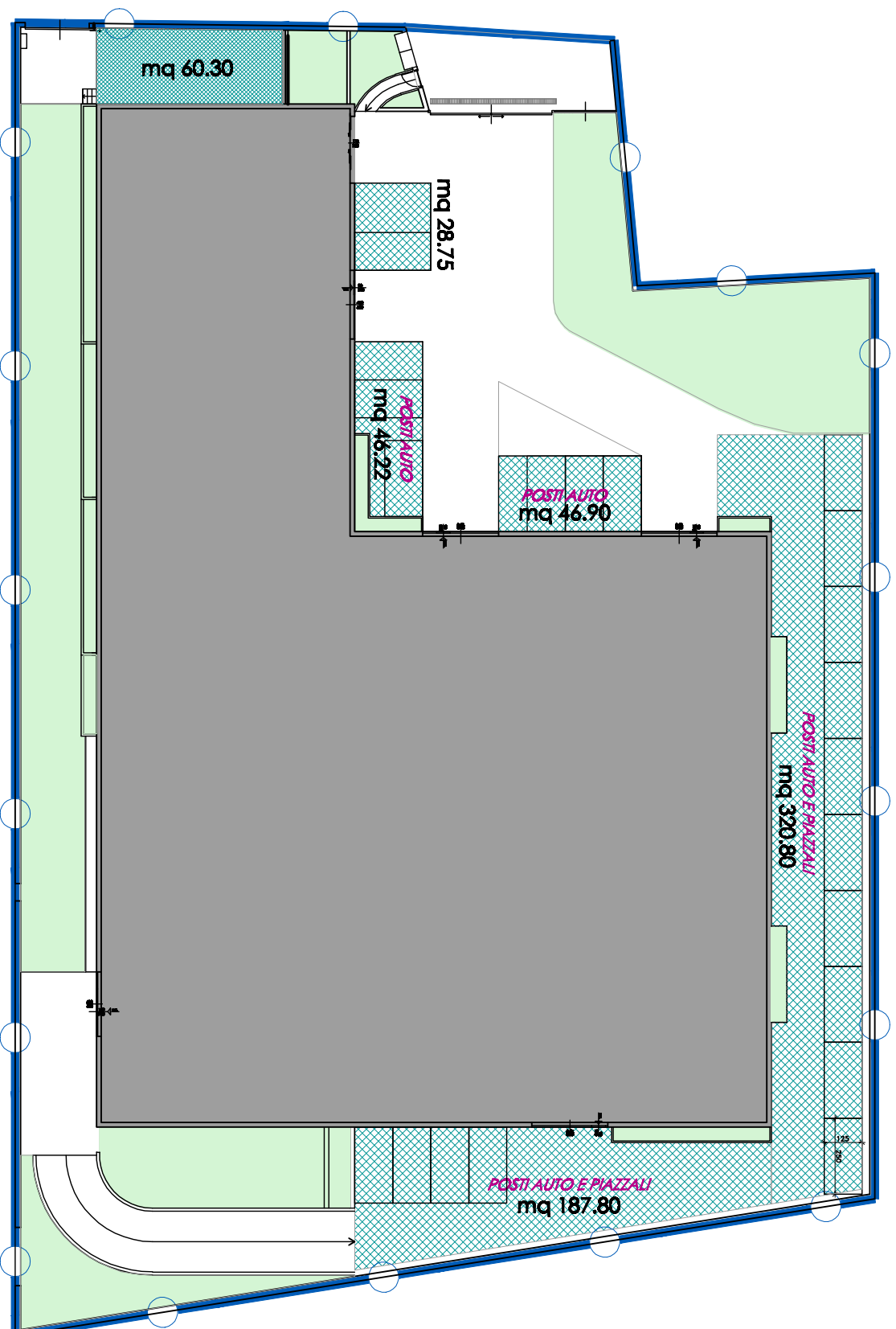

PLANIMETRIA IN PROGETTO

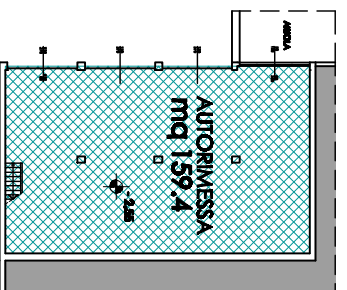

PIANTA PIANO SEMINTERRATO

CALCOLO E VERIFICA AREA A PARCHEGGIO

Area a parcheggio minima = 1 mq / 10 mc di superficie lorda di
pavimento = (esi.(808.28+212.92)+ampl.1800.30) = mq 2821.50
mq 2821.50 x 3.00H VIRTUALE = mc 8.464,50/10 = mq 846.45



SUPERFICIE PARCHEGGIO IN PROGETTO =

= mq 320.80+187.80+46.90+46.22+28.75+60.30+159.40 = mq 850.17
mq 850.17 > mq 846.45 - VERIFICATO -

(MISURATA CELERIMETRICAMENTE A COMPUTER)